

ITEM NO.	FPN	Drawing #	Description	QTY
1	065401	4315-3	Four Quart Tank, Integral w/Grommet	1
2	063366	063366	2.25" Top-Vent Fluids Cap w/Tether, WW, HDPE, Blk	1
3	066013A	066013	24 volt Pump	1

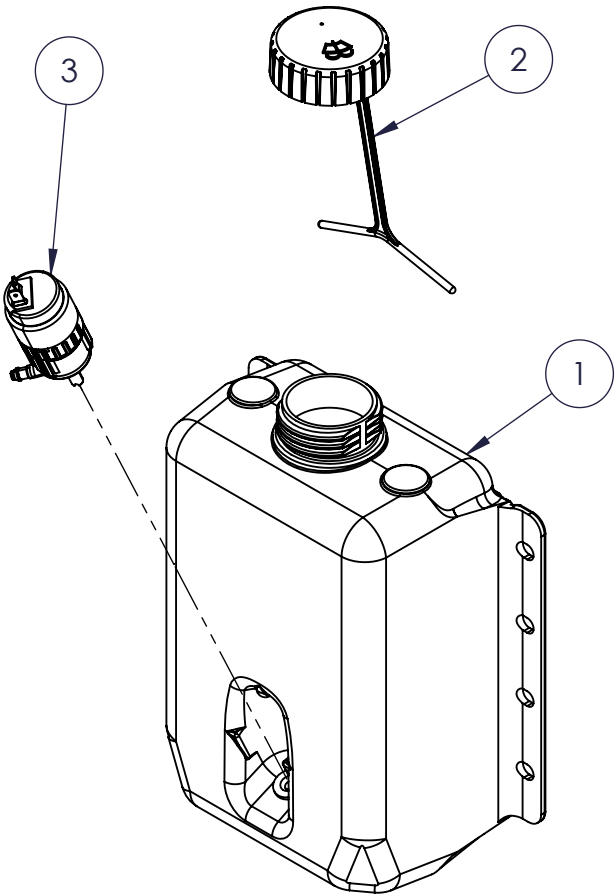

B	NPN	Redrawn, Pump was 066013	5-18-12	RDL	PSB
REV	ECR	DESCRIPTION	DATE	BY	APR
REVISIONS					

<div>PROPRIETARY AND CONFIDENTIAL</div> <div>THE INFORMATION CONTAINED IN THIS DRAWING IS THE SOLE PROPERTY OF FLAMBEAU, INC. ANY REPRODUCTION IN PART OR AS A WHOLE WITHOUT THE WRITTEN PERMISSION OF FLAMBEAU, INC. IS PROHIBITED.</div> <div>DIMENSIONS ARE IN INCHES. TOLERANCES: ANGULAR: ±3° TWO PLACE DECIMAL ±.13" THREE PLACE DECIMAL ±.060" DIMENSIONS IN PARENTHESIS () ARE FOR REFERENCE ONLY.</div>	SHT	<div><div><div>F</div><div>FLAMBEAU, INC.</div><div>911 LYNN AVENUE BARABOO, WI 53913 PH.(608)356-5551</div></div></div>			
	1	Scale: 1:3	BFI No: NA	Drawn By: RDL	Date: 5-4-12
		Mold No: NA	Mat'l: NA	FPN: 065402AE	
		Approvals			
		Eng:	MFG:	QLTY:	
	OF	Description:			
	1	4 Quart 24 Volt Washer Assembly			
		Customer: Flambeau Fluid System			Dwg No: 065402